

**THE COUNCIL OF THE BOROUGH OF MILTON KEYNES
(THE COUNCIL OF THE BOROUGH OF MILTON KEYNES
(CENTRAL MILTON KEYNES) (ON-STREET FREE AND LIMITED
PARKING PLACES AND WAITING RESTRICTIONS) ORDER 2002)
VARIATION ORDER 2013**

The Council of the Borough of Milton Keynes ("the Council") in exercise of its powers under Sections 45, 46, 49, 53 and Part IV of Schedule 9 of the Road Traffic Regulation Act 1984 ("the Act of 1984") and of all other enabling powers, and after consultation with the chief officer of police in accordance with Part III of Schedule 9 to the Act of 1984, hereby makes the following Order:-

PART 1

IMPLEMENTATION AND CITATION

1. This Order shall come into operation on 4th November 2013 and may be cited as "The Council of the Borough of Milton Keynes (The Council of the Borough of Milton Keynes (Central Milton Keynes) (On-Street Free and Limited Parking Places and Waiting Restrictions) Order 2002) Variation Order 2013".
2. Any plans annexed to this Order identify the lengths of road subject to this Order, provided that where there is any inconsistency between the plans and the Articles it is the wording of the Articles which shall prevail.
3. Any plans annexed to this Order are hereby annexed to The Council of the Borough of Milton Keynes (Central Milton Keynes) (On-Street Free and Limited Parking Places and Waiting Restrictions) Order 2002 and form part of the Order.
4. Any reference in this Order to any enactment shall be construed as a reference to that enactment as amended by any subsequent enactment.

PART 2

VARIATIONS

5. The Council of the Borough of Milton Keynes (Central Milton Keynes) (On-Street Free and Limited Parking Places and Waiting Restrictions) Order 2002 ("The Principal Order") is varied as provided by the following provisions of this Order:-

6. The following items are inserted into Schedule 2 of The Principal Order:-

**MIDSUMMER BOULEVARD, CENTRAL MILTON KEYNES -
THE SOUTH-EAST VEHICULAR ACCESSWAY – NORTH-WEST
SIDE**

- FP16a From Secklow Gate East to the south-western side of the porte cochere leading to Eagle Walk
- FP16b From the north-eastern side of the porte cochere leading to Eagle Walk to the access road leading onto Midsummer Boulevard situated between Secklow Gate and Lower Twelfth Street
- FP16c From the access road leading onto Midsummer Boulevard situated between Secklow Gate and Lower Twelfth Street to the south-western side of the porte cochere leading to Field Walk
- FP16d From the north-eastern side of the porte cochere leading to Field Walk for a distance of approximately 52.5 metres in a north-easterly direction

**MIDSUMMER BOULEVARD, CENTRAL MILTON KEYNES -
THE SOUTH-EAST VEHICULAR ACCESSWAY – SOUTH -EAST
SIDE**

- FP16e From Secklow Gate East to the porte cochere north-east of that point
- FP16f(i) From the north-east side of the porte cochere leading to Eagle Walk for a distance of approximately 15.2 metres in a north-easterly direction
- FP16f(ii) From a point approximately 24.7 metres north-east of the north-eastern side of the porte cochere leading to Eagle Walk to the south-western side of the porte cochere leading to Field Walk

7. The following item is inserted into Schedule 5 Part A of the Principal Order:-

**LOWER TWELFTH STREET, CENTRAL MILTON KEYNES -
NORTH-EAST SIDE**

- FP17 From a point approximately 7.2 metres south-east of the south-east vehicular accessway of Midsummer Boulevard for a distance of approximately 21.7 metres in a south-easterly direction to the entrance to the underground car parking area

MAP FOR TRAFFIC REGULATION ORDER

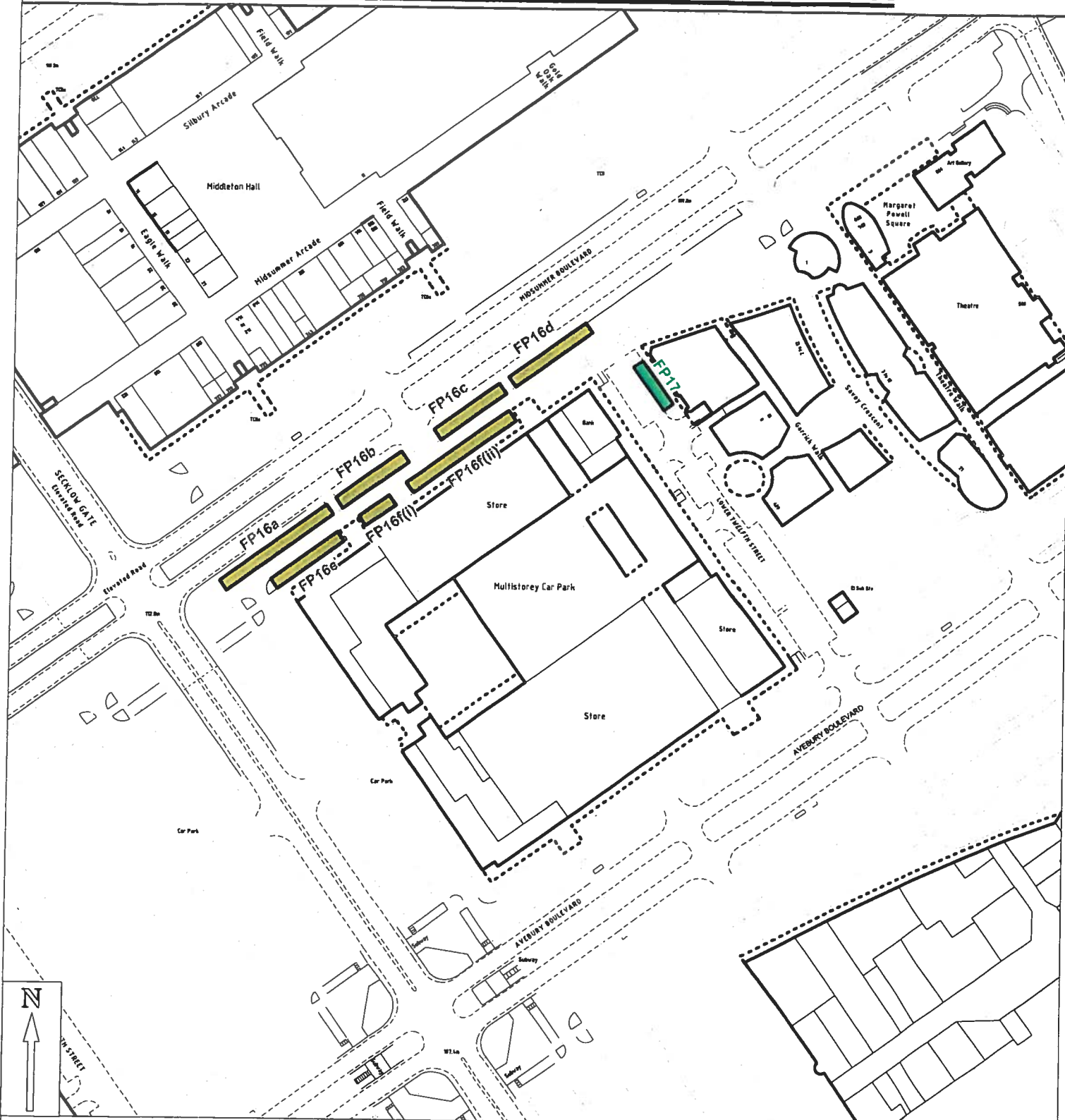

KEY:



Free Parking Places
3 hours limited waiting
No return within 2 hours

FP16a

TRO reference number



Free Parking Places
30 minutes limited waiting
No return within 1 hour

FP17

TRO reference number

Map Referred to in The Council of The Borough of Milton Keynes
(The Council of The Borough of Milton Keynes (Central Milton Keynes)
(On-Street Free and Limited Parking Places and Waiting Restrictions)
Order 2002) Variation Order 2013

The common seal of the Council of the
Borough of Milton Keynes was hereunto
affixed in the presence of:

Principal Solicitor - Law and Governance



21576

PART 3

REVOCATIONS

8. The following Order **IS HEREBY REVOKED** to the extent stated below:

The Council of the Borough of Milton Keynes (Central Milton Keynes)
(On-Street Free and Limited Parking Places and Waiting Restrictions)
Order 2002

Items FP2a, FP2b, FP2c, FP2d, FP3b, FP3c(i), FP3c(ii), FP5a, FP5b, FP5c, FP6, FP7 and FP8 are **HEREBY REVOKED IN THEIR ENTIRETY** from Schedule 1.

THE COMMON SEAL of the **COUNCIL OF THE BOROUGH OF MILTON KEYNES** was hereunto affixed this *29th* day of October 2013 in the presence of :-



.....
PRINCIPAL SOLICITOR – LAW & GOVERNANCE



21576